



USER MANUAL LED N750 LED (8W)

1 – ASSEMBLY DIAGRAM

2 - INSTRUCTIONS FOR USE

1 - ASSEMBLY DIAGRAM

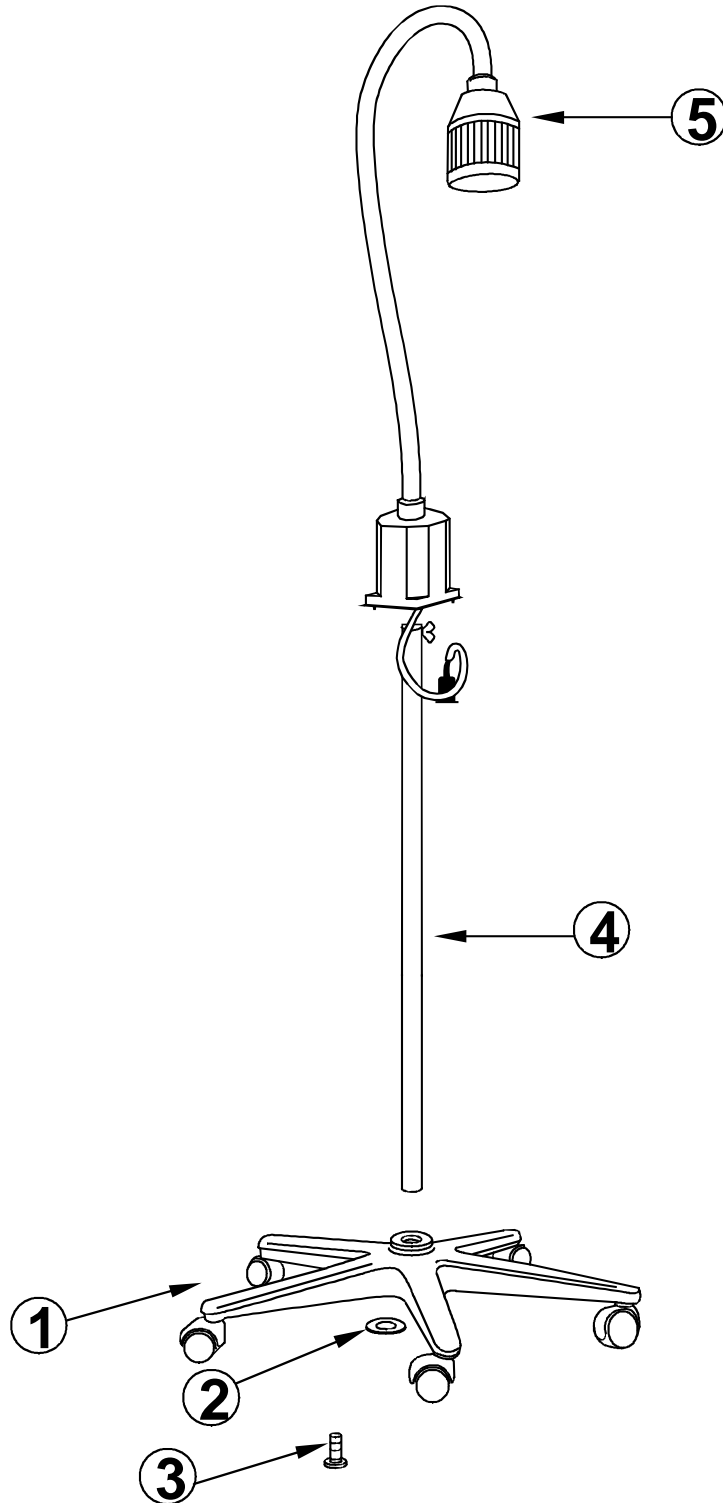



2 – INSTRUCTIONS FOR USE

Dear customer,

Congratulations on your purchase of VERRE & QUARTZ equipment, which will give you complete satisfaction.

To ensure that it is used correctly, we recommend that you read the following installation and operating instructions carefully.

1. MOUNTING

- If the lamp is fitted with a wall bracket, fix the bracket to the wall and insert the arm (5) into the bracket.
- If the lamp is fitted with a rolling base, insert the tube (4) into the rolling base (1). Position the washer (2) and tighten with the screw (3).
- Insert the lamp arm (5) into the tube (4) and secure the arm by tightening the butterfly screw.

2. COMMISSIONING

- Plug the mains lead into a standard 230Vac/50Hz 10/16A socket.
- All our lamps are fitted with an ON/OFF switch to switch the lamp on or off.

3. TECHNICAL CHARACTERISTICS

- Wattage 8W - Voltage 230Vac 50Hz
- Bulb 8W - Arm length 720 mm

4. USE

- The VERRE ET QUARTZ N750 LED lamp is designed for precise medical examinations.

1. PRECAUTIONS AND MAINTENANCE

- Maintenance: To be carried out only by qualified electricians or other qualified personnel.
- To replace the light source:
 - Always unplug the luminaire before carrying out maintenance.
 - Remove the light source cover (Figure 1).
 - Remove the light source with both hands
 - And place the new light source.
 - Replace the cover ring (illustration 2).



1. GUARANTEE

Your lamp is guaranteed for 2 years, parts and labour in our workshops under normal use, except for worn parts and bulbs.